

FRAMA Fx Series 7, 7.5 and 9 **USER MANUAL F-LINK 2**



Table of contents

LAN connectivity	2
LAN wireless connectivity	6
Appendix	10

LAN connectivity

The LAN connectivity works for the Frama Fx Series 7, 7.5 and 9.

LAN connection

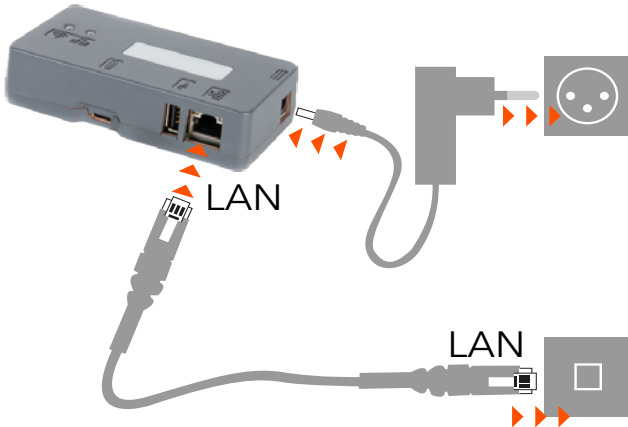

Plug in the **Power Adapter** and wait until both status lights are lit

Plug the **LAN cable** between the F-Link 2 and the customer network

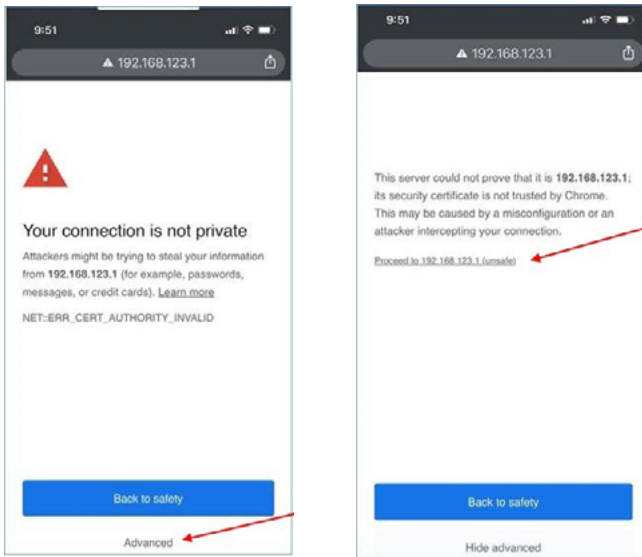

On your **Mobile Phone**, look in wireless setting for available networks. Search for a network that starts with: **Connect-A001245** Select this network and enter the **Password: Nconnect**

Open an internet browser on this phone and enter the following URL: **https://192.168.123.1**

You may see a warning that the connection is not private. Please click on the **Advanced-tab** in your browser to proceed to <https://192.168.123.1>

Now, you will be allowed to sign in. Use the following login:

Login: admin
Password: admin

Configuration of Modem / Router mode for F-Link 2

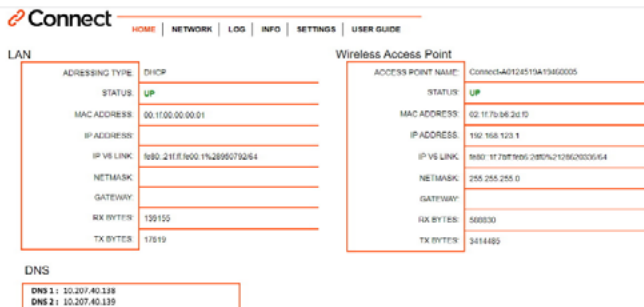

Step 1:

Note: With your mobile phone, you must be connected with the box to modify settings

On **Home** page: the LAN status should be **UP** and the IP address should be different from 192.168.123.1

Change parameters for Lan Interface

DHCP
 Static

Ip address:

NetMask:

Gateway:

DNS 1:

DNS 2:

192.168.123.1 indique

lan success

Change parameters for IS machine

Name server for On-Line Services:

Port number for On-Line Services:

Name server for Postal Core:

Port number for Postal Core:

Therewith the configuration of the F-Link 2 has been completed.

Step 2:

Go to **NETWORK/LAN** page

Next, set the following parameters:
 Select **Static** (not DHCP)

Sample settings. Ask the Network administrator for correct IP credentials:

IP address: **192.168.99.1**
 NetMask: **255.255.255.0**
 Gateway: **192.168.0.1**
 DNS 1: **8.8.8.8**
 DNS 2: **8.8.4.4**

Then, click the **Submit** button

Success Information

Step 3:

On **Settings / IS/IN/IX** enter **URL Settings** of F-Link 2

CH

On- Line Services: **chfr-MeterServices.link0-neopost.com**
 Server Postal Core: **chfr-MeterServices.link0-neopost.com**
 Port number: **443**

UK

On- Line Services: **ukfr-MeterServices.link0-neopost.com**
 Server Postal Core: **ukfr-MeterServices.link0-neopost.com**
 Port number: **443**

Then, click the **Apply** button

Configuration of Fx Series franking systems

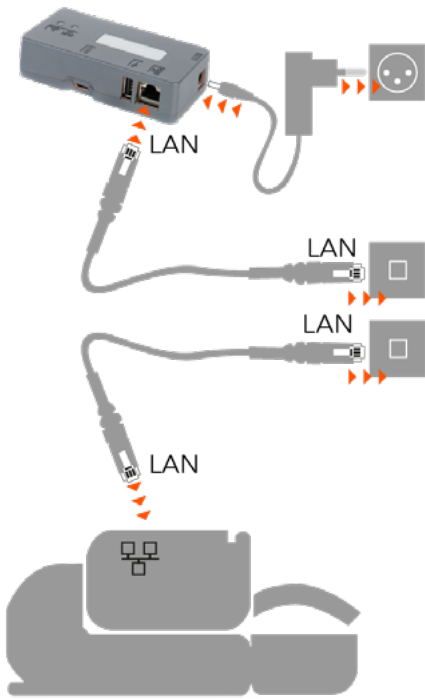

Plug in the **LAN cable** to the Internet wall socket

Plug in the **LAN cable** to the base and the Internet wall socket

Power up the F-Link 2

Franking Systems Configuration

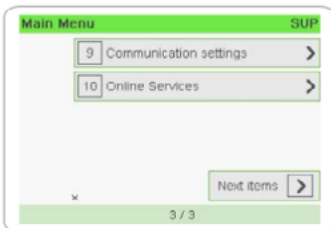

Step 1:

On the Franking Systems go to Supervisor Mode (Manger) and then to **Communication Setting** and configure following parameters

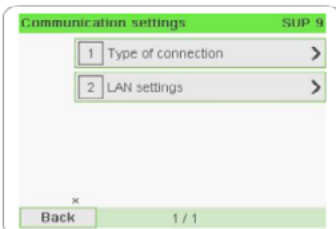

Next, select **LAN settings**

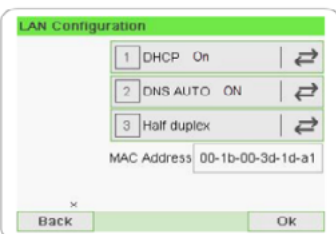

In **LAN configuration** select **DHCP ON**

Also select **DNS AUTO ON**

Confirm with **OK**

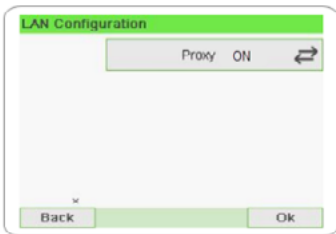

Next screens just confirm until you reach Proxy menu

Set Proxy to **ON**
 Confirm setting with **OK**

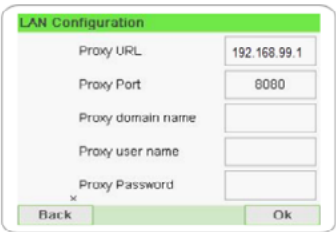

In Proxy configuration enter the following credentials:

- Ask the customer IT administrator for correct credentials
- Proxy-URL **192.168.99.1** (static **IP address** from the F-Link 2)
 - Proxy-Port **8080**
 - If required: **Proxy Domain name, User name and Password**

Confirm with **OK**

Note: Next screens just confirm with **OK** until you reach **Communication settings** again

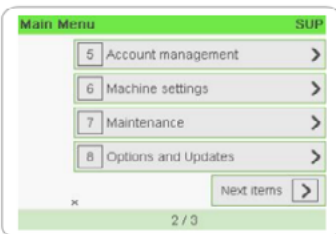

Step 2:

In **Superuser access (Manager)** go to

- **Menu System Info (DE)**
- **Menu Maintenance (EN)**

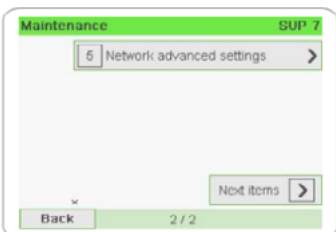

Select

- **Netzwerkeinstellungen (CH)**
- **Network Advanced Settings (UK)**

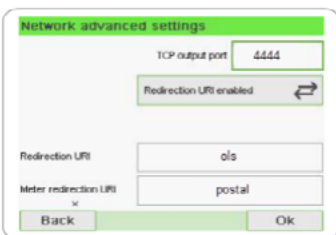

In Network configuration enter the following credentials:

- TCP output port: **4444**
- Activate **URI redirection** menu
- Redirection URI (OLS): **ols**
 - Redirection URI (PSD): **postal**

Note: Write URI information in small letters

Confirm with **OK**

Congratulation! The F-Link 2 and the Franking Systems are successfully configured for Router mode.
 However, make sure the F-Link 2 is fully functional by performing a Postal Inspection and an OLS Generic call on the franking systems.

LAN Wireless connectivity

The LAN Wireless connectivity works for the Frama Fx Series 7, 7.5 and 9.

Connect by Wireless

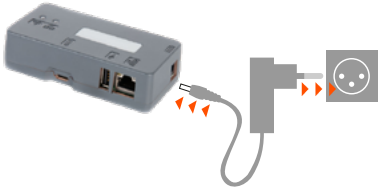

Plug in the **Power Adapter** and wait until the status lights are lit

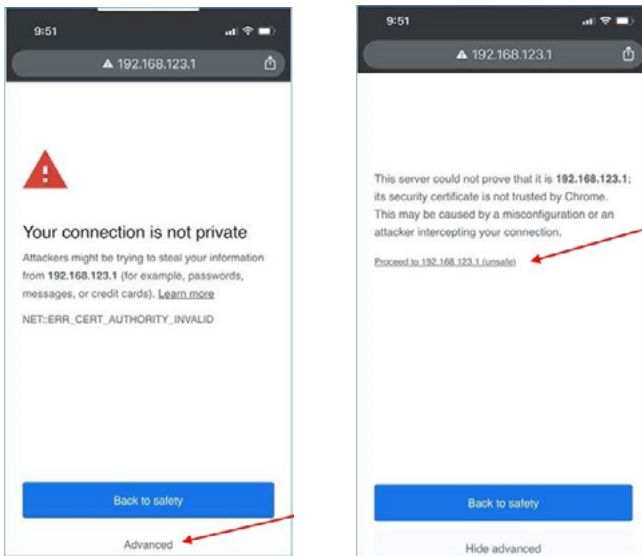

On your **Mobile Phone**, look in wireless setting for available networks. Search for a network that starts with: **Connect-A001245** Select this network and enter the **Password: Nconnect**

Open an internet browser on this phone and enter the following URL: **https://192.168.123.1**

You may see a warning that the connection is not private. Please click on the **Advanced-tab** in your browser to proceed to https://192.168.123.1

Now, you will be allowed to sign in. Use the following login:
Login: admin
Password: admin

Configuration of Wireless mode for F-Link 2



HOME | NETWORK | LOG | INFO | SETTINGS | USER GUIDE
LAN | WIRELESS STATION | WIRELESS ACCESS POINT

Change parameters for Lan Interface

DHCP	<input type="radio"/>
Static	<input checked="" type="radio"/>
Ip address	<input type="text" value="192.168.99.1"/>
NetMask	<input type="text" value="255.255.255.0"/>
Gateway	<input type="text"/>
DNS 1	<input type="text" value="8.8.8.8"/>
DNS 2	<input type="text" value="8.8.4.4"/>
	<input type="button" value="Submit"/>

Note: With your mobile phone, you must be connected with the box to modify settings

Step 1:

In the navigation, select **Network /LAN**

Next, set the following parameters:
Select **Static** (not DHCP)

Sample settings. Ask the Network administrator for correct IP credentials:

IP address: **192.168.99.1**
NetMask: **255.255.255.0**
Gateway:
DNS 1: **8.8.8.8**
DNS 2: **8.8.4.4**

Then, click the **Submit** button

Change parameters for IS machine

Name server for On-Line Services:

Port number for On-Line Services:

Name server for Postal Core:

Port number for Postal Core:

Apply

192.168.123.1 indique
 connected to ssid: Livebox-AF90

OK

Connect to a station

Choose	Station	dBm	Signal	Security
<input type="radio"/>	Livebox-AF90	-43.00		Secured
<input type="radio"/>	IOT10210b32u	-49.00		Secured
<input type="radio"/>	freebox_RQILYI	-71.00		Open
<input type="radio"/>	FreeWifi	-72.00		Open
<input type="radio"/>	FreeWifi_secure	-73.00		Secured Enterprise
<input type="radio"/>	AndroidAP5FBB	-95.00		Secured

Connect

Connect to: Livebox-AF90

Show Password

Cancel **Connect**

192.168.123.1 indique
 connected to ssid: Livebox-AF90

OK

Step 2:

On **Settings / IS/IN/IX** enter **URL Settings** of F-Link 2

CH

On- Line Services: **chfr-MeterServices.link0-neopost.com**
 Server Postal Core: **chfr-MeterServices.link0-neopost.com**
 Port number: **443**

UK

On- Line Services: **ukfr-MeterServices.link0-neopost.com**
 Server Postal Core: **ukfr-MeterServices.link0-neopost.com**
 Port number: **443**

Then, click the **Apply** button

The success information appears

Note: From configuration LAN to WI-FI, check in **Menu, advanced Network Settings: URI = OFF Port = 443**

Step 3:

In the navigation, select **Wireless Station**. You will see a list of Wireless networks with their SSIDs displayed

Select the corresponding Wireless network and click **Connect**

The security description is to be understood as follows:

- Open: no password required
- Secured: password required
- Secured Enterprise: administrator required

Next, enter the **password** of your WLAN and click „**Connect**“

After that, you should receive a success information Press **OK**

Note: The WI-FI is activated if the green LED is lightnig

The F-Link 2 is now connected to WI-FI. Now, the configuration of the franking machine will take place.

Configuration of Fs Series 3 franking systems

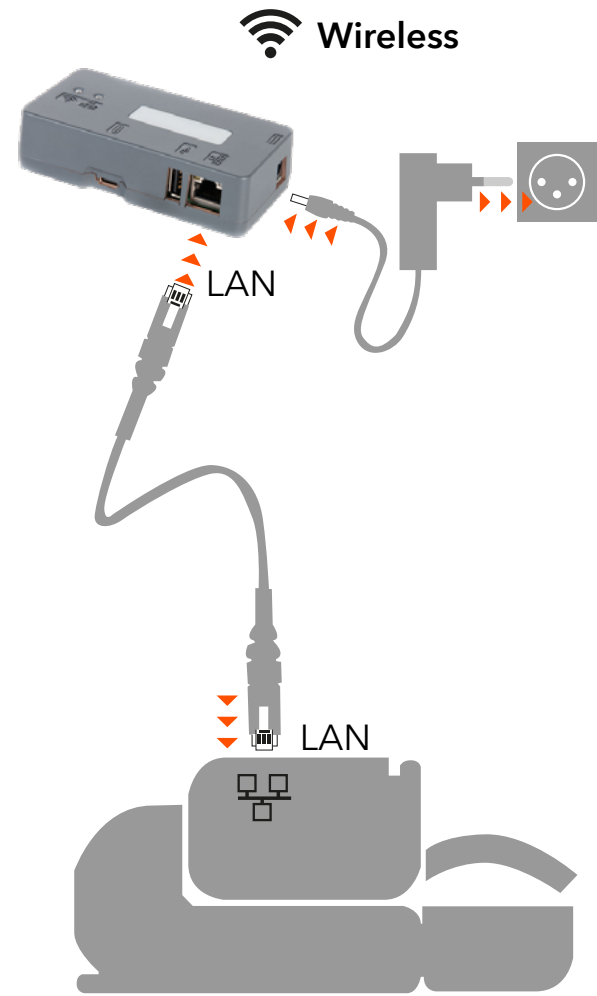

Plug the LAN cable between the F-Link 2 and the franking systems

Power up the F-Link 2 if it's not already powered up

Franking Systems Configuration

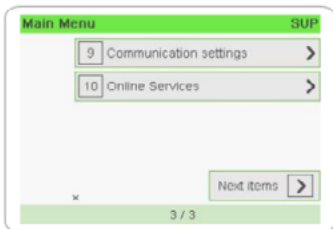

On the Franking Systems go to Supervisor Mode (Manger) and then to **Communication Setting** and configure following parameters

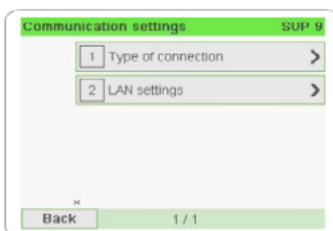

Next, select **LAN settings**

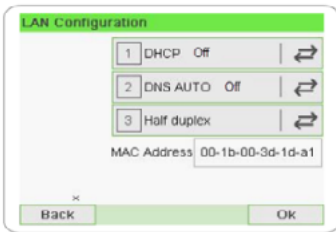

In Menu **DHCP configuration** select **DHCP OFF** to enter the fix IP



Following images showing sample IP setting. Ask your network administrator for correct credentials.

Note: with button **C** clear first all information being able to enter the IP address

- Machine IP address: **192.168.99.3**
- Subnet Mask: **255.255.255.0**
- Default Gateway: **192.168.99.1** (IP address of the F-Link 2)

Confirm with **OK**

Enter **8.8.8.8** for the **preferred DNS** IP address

Enter **8.8.4.4** for the **alternate DNS** IP address

Press **OK**

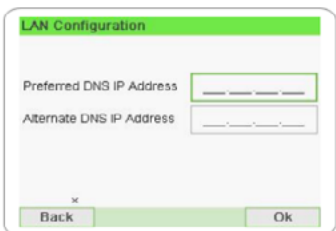

Select **Proxy off** and confirm with **OK**

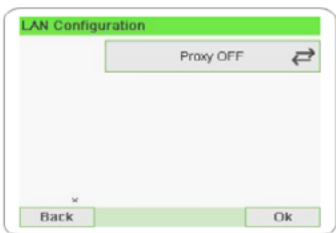

The F-Link 2 is successfully setup once you see **both green lights** on



Congratulation! The F-Link 2 and the Franking Systems are successfully configured. However, make sure the F-Link 2 is fully functional by performing a Postal Inspection and an OLS Generic call on the franking machine.

Appendix

To switch off Wi-Fi mode

To disable the current Wi-Fi mode go to **Wireless Station**, press **Connect** and enter an incorrect **Password**. Wait until the message „Impossible to connect to ssid“: appears.

The green Wi-Fi Led turns to yellow. The chosen Wi-Fi station is disabled.

To Reset F-Link 2 to Factory Default

Step 1:

Connect a USB key (drive) to a PC. Make sure the key is formatted for FAT32.

Step 2:

Create a text file on the root directory of the key and name it 'ifreset' then save.

Click on the new file and change the extension from '.txt' to '.cmd'.

Remove the key from the PC.

Step 3:

Power off the F-Link 2 and insert the USB key into the USB port.

Switch On the F-Link 2.

Wait until the Wireless LED turns amber and the box has been reset.

Specifications

Connect Box Typ: A0124519

Connectivity:	RJ 45 Lan Connector USB 2.0 Host Connector
Core System:	CPU : NXP i.MX6UL @ 528MHz, ARM Cortex-A7, up to 1GB DDR3L
Power Specification:	Power Connector 5.5 / 2.1mm barrel jack External Power Supply 5V DC +/- 5% 1,2A Safety: UL/CUL,CB,GS,CE,FCC
Wireless Qualcomm:	Dual mode 802.11 a/b/g/n/ac up to 480Mbps. 2.4 Ghz FlexNotch Antenna
Wireless security:	WPA2-PSK, WPA-PSK
Compliance:	EN55032/24. CE, FCC Part 15C, ID 2AKZA-QCA9377, IC 22364-QCA9377
Speed:	Lan 10/100 Mbps
Temperature:	0° to 40°
Humidity Operating:	20% to 80%
Dimensions:	105 x 54 x 27 mm
Protocols/Port:	TCP/IP V4.0 TLS V1.2 / Port 443
Certificate:	Public
Key:	RSA key, 2048 bits